



NEW CONSTRUCTION

DRYWALL INSTRUCTION



! IMPORTANT! READ ALL INSTRUCTIONS BEFORE BEGINNING INSTALLATION.

The manufacturer will accept no responsibility for air or water leakage above, under, or around the window unit. For further assistance, contact **Ply Gem Windows at 1-888-9PLYGEM.**

CAUTION: You are about to expose sharp edges of glass that can cause serious injury or death if they are not handled properly, and with recommended safety equipment. Gloves, arm guards, and a leather apron are strongly recommended when removing the insulated glass assembly.

THIS IS A DRYWALL WINDOW. It does not require any changes from the factory, but it can be disassembled to pass construction materials through by following these steps:

STEP 1. Make sure the window is fully shimmed and fastened into the wall. Once this is done, remove the bottom sash and screens from the interior.

NOTE: Be careful to not damage the vinyl glazing, vinyl frame or glass – all parts must be replaced later.

Starting on the vertical glazing beads, use a small (about 1 inch wide) putty knife to pry loose about four inches of one end of the glazing bead, then gently pull it straight out toward you. **(Figure A)** Do the same on the bottom horizontal, being careful not to catch the bead on the top of the keeper. Finish by removing the top glazing bead. Be aware that when the last glazing piece is removed, the insulated glass assembly can fall out. Remove glass. Collect all loose spacer blocks and save for reuse.

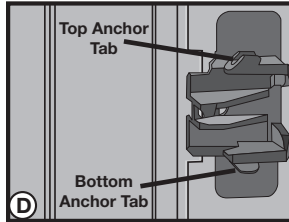
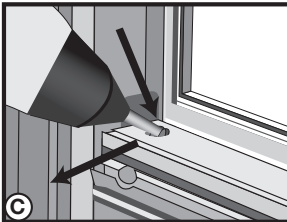
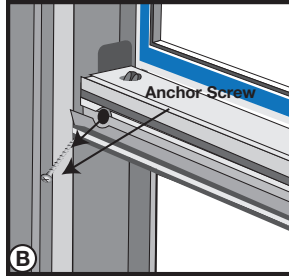
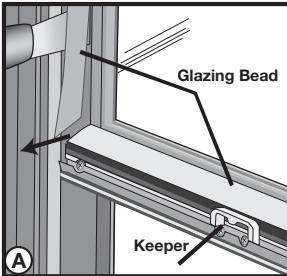

STEP 2: Remove the meeting rail.

Remove the two angled screws located at each end of the meeting rail. **(Figure B)** Then, using your screw driver tip, push down on the anchoring tab located on the top of the meeting rail, and pry the meeting rail inward until it comes loose from the anchoring tab. **(Figure C)** Do the same actions on the underside of the meeting rail so that the meeting rail comes completely loose on that end. Repeat on the other end, being careful not to twist the meeting rail at the ends. Save all parts for the reinstallation and glazing.

RESTORE WINDOW TO NORMAL USE and GLAZE

STEP 3. Reinstalling the meeting rail. Align the meeting rail with both jambs and slide the meeting rail over the top and bottom anchoring tabs, **(Figure D)** (weather-stripping to the inside, and the keepers facing up). Place screws back in their original holes and tighten – **DO NOT OVER TIGHTEN.** The Screw head should be sticking out slightly.

STEP 4. Set glass over the keepers onto the spacer blocks **(Figure E)** (window label upright to the inside). **PUSH IT UP AGAINST THE COMPRESSION TAPE ALL THE WAY AROUND, AND BE SURE GLASS IS PROPERLY ALIGNED AND EVENLY SPACED** within the opening

STEP 5. Replace the Interior Vinyl Glazing Beads. Start with the TOP piece, bottom piece next and then side pieces. Insert the shorter leg of the glazing bead into the glazing groove, starting at one end. Press it in until it snaps into place along the entire piece. Be careful to not damage glass or the bead.

STEP 6. Replace screen and bottom sash.

